



# ORDER FORM COVER SHEET

1208 Houston Clinton Dr., Burnet, Texas 78611  
(512) 715-0808 | Toll-Free: (833) 715-0810 | Fax: (512) 715-0811  
ORDERS@GIBRALTARGLOBAL.COM

**COMPLETE AND RETURN ALONG WITH YOUR ORDER FORM TO THE EMAIL OR FAX LISTED ABOVE.**

**\*\* PLEASE ALLOW 3-5 BUSINESS DAYS TO PROCESS ORDERS PLUS SHIPPING/TRANSIT TIME \*\***

<b>DATE:</b>	
<b>COMPANY NAME:</b>	
<b>CONTACT NAME:</b>	
<b>PHONE NUMBER:</b>	
<b>FAX NUMBER:</b>	
<b>EMAIL:</b>	

\* PLEASE INCLUDE YOUR EMAIL ADDRESS SO WE CAN SEND YOU AN ORDER CONFIRMATION FOR APPROVAL PRIOR TO SHIPPING (BE SURE YOUR EMAIL ADDRESS IS LEGIBLE)

<b>PO NUMBER:</b>	<b>COUNTY &amp; STATE:</b>
-------------------	----------------------------

<b>SHIPPING ADDRESS:</b>	<b>BILLING ADDRESS:</b>

<b>SHIPPING CONTACT:</b>		<b>RECEIVING HOURS:</b>	
<b>SHIPPING PHONE:</b>		<b>RECEIVING HOURS:</b>	

<b>Notes:</b>

FOR QUESTIONS REGARDING ORDERS PLEASE CONTACT JOHN JANSEN AT (512) 715-0808. ORDERS@GIBRALTARGLOBAL.COM

FOR TECHNICAL QUESTIONS CONTACT INFO@GIBRALTARGLOBAL.COM

**\*\* PRICES DO NOT INCLUDE SHIPPING & HANDLING CHARGES \*\***

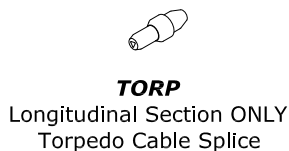
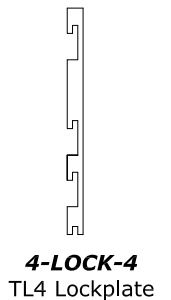
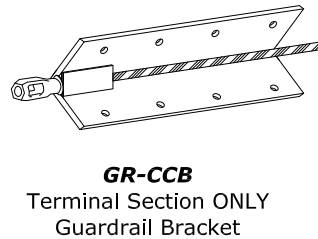
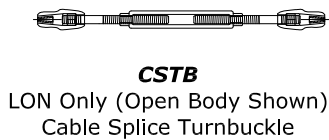
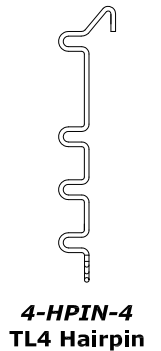
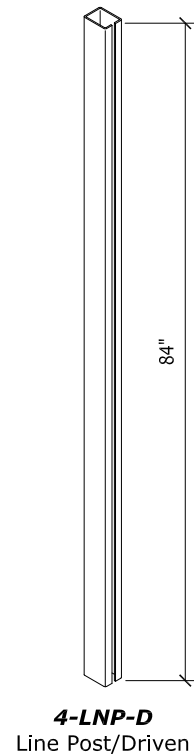
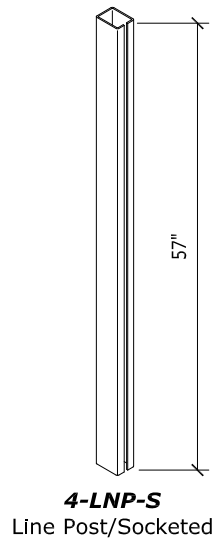
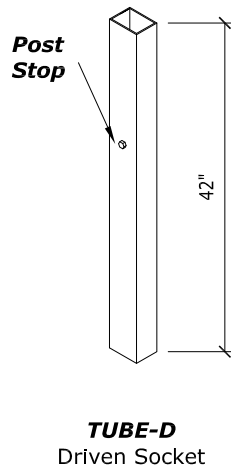
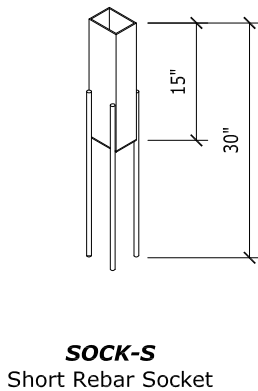
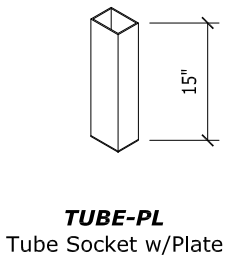
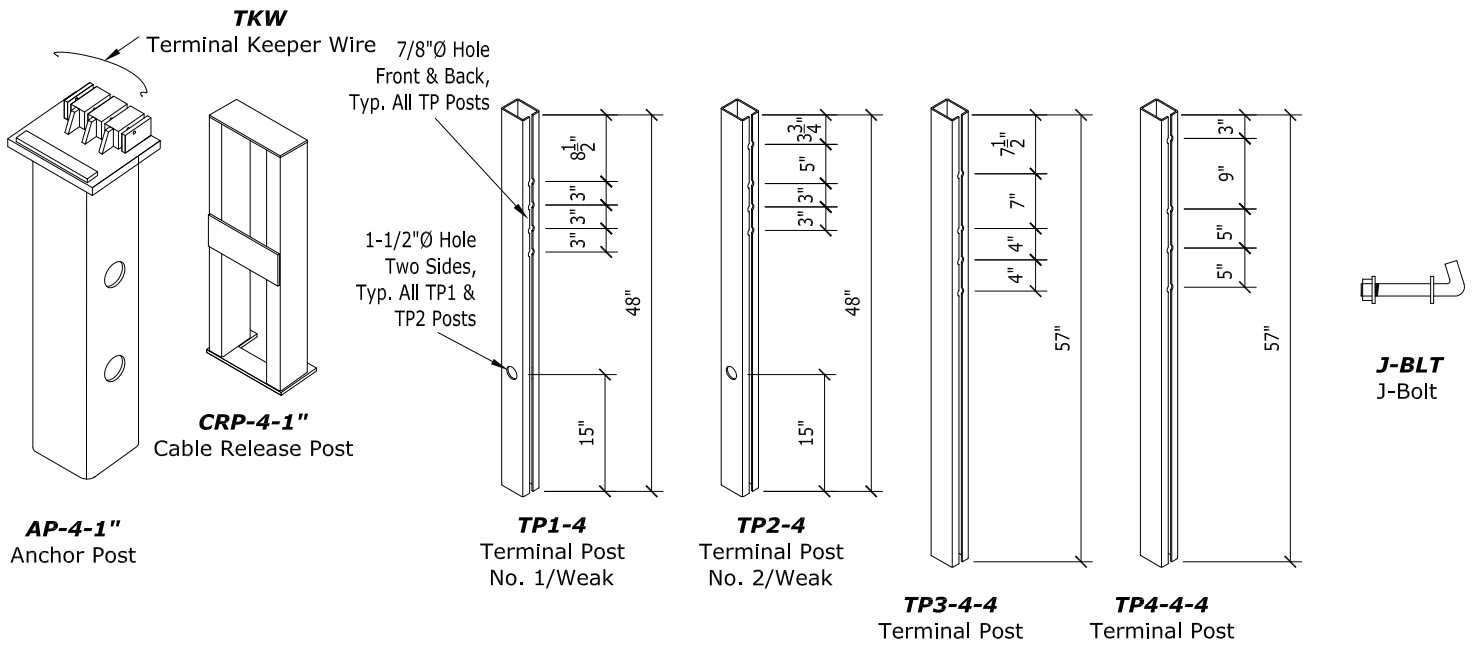

**PROPRIETARY TO GIBRALTAR**



**TL4-4 Cable System Parts**

Gibraltar Cable Barrier Systems

Scale:	NTS	Date:	10-18-17
Layout:	ANSI B	Drafter:	BH



**TO ORDER REPLACEMENT PARTS, CONTACT:**

Gibraltar Global LLC  
 1208 Houston Clinton DR  
 Burnet, TX 78611

Toll Free: (833) 715-0810 Office:(512) 715-0808  
 Email: ORDERS@gibraltarglobal.com Fax: (512) 715-0810

SYSTEM TYPE: TL4- 4 CABLE w/ 3/4" OR 1" FITTINGS

PART #	ITEM / DESCRIPTION	PRICE	UNIT	QUANTITY	EXTENDED AMT
4-HPIN-4	TL-4 4 Cable Hairpin		EA		
4-LOCK -4	TL-4 4 Cable Lockplate		EA		
U-LOCK	U-Bolt Lockplate Assembly (Consists of Lockplate and 4 U-blts)		SET		
4-LNP-S	TL-4 Line Post / Socketed (57")		EA		
4-LNP-D	TL-4 Line Post / Driven (84")		EA		
AP-4	Anchor Post - 4 Cable		EA		
SOCK-S	30" Socket 4" x 3" -15" long W/ (4) 16" bars		EA		
TUBE-PL	15" Tube Socket 4" x 3" with welded plate		EA		
TUBE-D	42" Driven Socket 4" x 3" with Post Stop at 15"		EA		
CRP-4-1"	Cable Release Post -4 Cable		EA		
TKW	Terminal Keeper Wire (12-Ga.x 12" long)		EA		
TP1-4C	Terminal Post No.1/ Weak 48" (4-Hole)		EA		
TP2-4C	Terminal Post No.2/ Weak 48" (4-Hole)		EA		
TP3-4-4C	Terminal Post No.3/ Standard 57" (4-Hole)		EA		
TP4-4-4C	Terminal Post No.4/ Standard 57" (4-Hole)		EA		
J-BLT	J-Bolt (3/4")		EA		
ATF	Anchor Terminal Fitting (3/4") Includes Turnbuckle		EA		
ATF-End	Anchor Terminal Fitting End - 18" x 3/4" Rod with Acorn		EA		
ATF 1" Milled	Anchor Terminal Fitting - 1" Milled to fit 3/4" gap in AP		EA		
CSTB	Cable Splice Turnbuckle (3/4") Open Body		EA		
ATF-1"	Anchor Terminal Fitting (1") Includes Turnbuckle		EA		
ATF-End 1"	Anchor Terminal Fitting End 1 18" x 1" Rod and Acorn		EA		
CSTB-1"	Cable Splice Turnbuckle (3/4") Open Body		EA		
TORP	"Torpedo" Splice		EA		
ACORN	Acorn		EA		
WEDGE	Wedge For Acorn		EA		
DLN	Delineator / Reflective Object Marker - <b>Specify Yellow or White</b>		EA		
CBL-PRE	Pre-stretched Cable (3/4" Guardrail Cable) *[See Note 1]		LF		
EXCL-CAP	Excluder Cap - Post Base		EA		
CAP	Post Cap Sleeve - Post Top		EA		
T-MTR	Tension Meter with Case		EA		
<b>NOTE-1</b>	<b>Cable sold as a complete 2000' spool only (unless remnant pieces are available)</b>				
				<b>PARTS TOTAL</b>	
				<b>SHIPPING &amp; HANDLING</b>	
				<b>ORDER TOTAL</b>	